

REBS®

COMPACT LAUNCHER V.2

The Compact Launcher is a smaller version of the larger REBS Launcher, and has been developed for more versatile use than the big brother. Whereas the REBS Launcher is designed to be the ultimate boarding tool with unmatched performance, the Compact Launcher is designed to be a light weight, compact in size line thrower for many different applications.

The Compact Launcher is a high performance pneumatic launcher that has been designed for use in maritime and urban environments. The Compact Launcher grants high reliability, reach and versatility.

Based on end user experience from the bigger REBS® launcher and customer requests, the Compact Launcher with collapsible stock was designed. The system is very effective to use in many scenarios including diving, boat-based and land-based climbing operations.

The Compact launcher is powered by pressured air and the 0.35 L bottle can be easily be re-filled from a normal 300 bar diving bottle. Lower pressure diving systems can also be used to charge the tank. Users can set the firing pressure on the fly depending on the height needed. A compact rope container can be mounted on the barrel and fits 115 ft of 8 mm rope or 53 ft of rope ladder. Multiple shots can be fired from a single bottle charge.

The Compact Grapnel with spring-loaded folding arms will hook into any object such as wire, fences, railings, and structural and natural features. It can be used to deploy a climbing rope, flexible ladder or a horizontal traverse line.

The Piston Kit upgrade reduces both recoil and sound levels, providing both tactical and HSE benefits. Contact us for more information.



It is easy to maintain and has a long and robust service life with proper post operations care. The Compact Launcher leverages the 12+ years of operational service and lessons from its “big brother”.

The Compact launcher is available in several kit options. A custom made transportation and storage box makes the Compact Launcher highly transportable and user friendly.



Specifications

Maximum height with grapnel	35 m / 114.8 ft
Maximum height with rope ladder	16 m / 52.5 ft

COMPACT LAUNCHER SYSTEM OVERVIEW

MOST COMMON PARTS

REBS Compact Launcher
BE000083



Bottle 0,35 liter Aluminium
BE004204



Rope/Ladder Container
BE004262



REBS Grapnel
BE007838

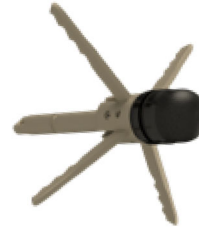

REBS Rope DYNEEMA ø8 mm 40 m Black
BE004343



Maintenance Kit
BE004878



Fill Line Valve
BE004263



REBS Rope Ladder 16 m
BE002458



Compact launcher Carry System
BE000400



REBS Web Ladder for Launcher 25 m
BE002561



Piston Kit
BE000057



COMPACT LAUNCHER STANDARD PACKAGE

REBS Compact Launcher packages		Standard Package BE000165
Part	Part no.	Pcs.
REBS Compact Launcher	BE000083	1
Piston Kit	BE000057	1
Bottle 0,35 liter Aluminium	BE004204	1
Rope/Ladder Container	BE004262	1
REBS Grapnel	BE007838	2
REBS Rope DYNEEMA ø8 mm 40 m Black	BE004343	1
Maintenance Kit	BE004878	1
Fill Line Valve	BE004263	1
Web Ladder for Launcher	BE002561	1
REBS Rope Ladder 16 m	BE002458	1
Compact Launcher Carry System	BE000400	1

COMPACT LAUNCHER CARRY SYSTEM NEW!

The Compact Launcher Carry System is developed to make it easier to carry the Compact Launcher during operations. With this bag you may easily bring the Compact Launcher as a backpack or a bag, This also suits into the hard Storage Box.



Soft Bag that fits within the Storage Box



The Bag contains everything you need for an operation.



Spareparts, Grapnels, Maintenance Box and Fill Line Valve are below the bag in the box.



The Storage Box

COMPACT LAUNCHER SPECIFICATIONS

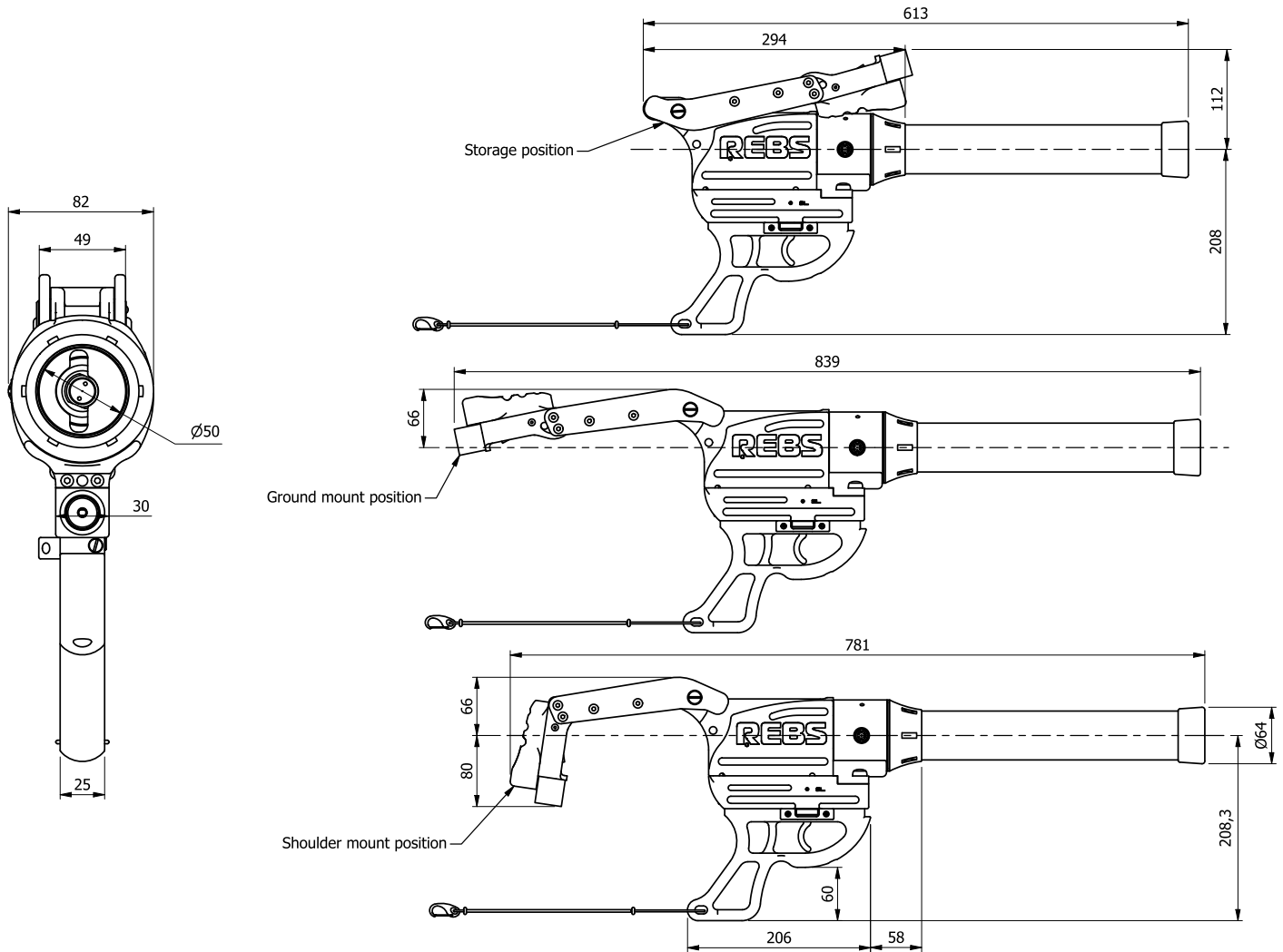

Specifications	
Bore	50 mm / 2.17"
Length assembled with stock out	839 mm / 33"
Weight (without grapnel and rope)	4,4 kg / 9.7 lbs
Standard grapnel length	252 mm / 9.92"
Standard grapnel weight	792 gram / 1.75 lbs
Standard grapnel MBL (tip)	420 kg / 926 lbs
Pressure air bottle	0,35 liter / 300 bar
Grapnel maximum height (vessel position)	Rope $\varnothing 8$ mm / 0,32": 35 m / 114.83 ft (vertical)
Grapnel maximum distance (man held position)	Rope $\varnothing 6$ mm / 0,24": 60 m / 196.85 ft (horizontal)
Grapnel maximum height (vessel position)	Ladder : 16 m / 52.5 ft (vertical)
Capacity rope container	$\varnothing 6$ mm : 2 x 30 m
Rope size	$\varnothing 6 - 11$ mm / 0.2 - 0.4"
Rope ladder length	16 m / 52.5 ft